

# Tech SIGHTS

## Detailed Instructions for Installing Aperture

The first thing to do is lay a towel down on the table where you will be working on the sight. The sight has a small washer, ball detent, and spring that can easily get lost if they fall out and roll away. The towel will help contain the small parts.

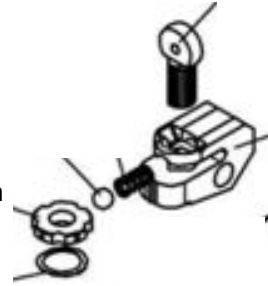

We recommend using the TS211 sight adjusting tool, but you can use a pointed object like a bullet tip or a hardwood dowel. Rotate the elevation dial CW so that the aperture is being raised. Continue to rotate the dial until the aperture is all the way up and falls out of the sight. Then the elevation dial and washer will come out and the small detent ball will be free to fall out.

Notice on the threaded portion of the aperture there are flat areas. The flat areas are at a 90 degree angle to each other forming a "V". The "V" needs to go toward the back of the gun, toward the shooter.

With the spring installed, put the ball detent back in and put the washer on the bottom "ribbed" side of the elevation dial. Push the dial with washer into the slot so it starts to compress the spring behind the ball detent. Once the dial is in position push the new aperture down into the elevation dial through the sight body.

While holding the aperture down with one hand, which will hold the elevation dial in place, rotate the elevation dial CCW so the threads start to catch on the aperture. Once you get the threads started, continue rotating the dial CCW until the aperture is pulled down into the sight body a decent amount.

Then you are ready to zero with the new aperture installed.