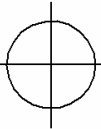

**Tech**  **SIGHTS™**

Precision Shooting Accessories

**INSTRUCTIONS  
for Installing the  
Insert Ready  
Aperture System**

Replacement Part Prices -

- TS00227 - Steel Aperture .125 opening - \$9.00
- TS00224 - .042 opening - \$2.50
- TS00225 - .062 opening - \$2.50
- TS00226 - .086 opening - \$2.50

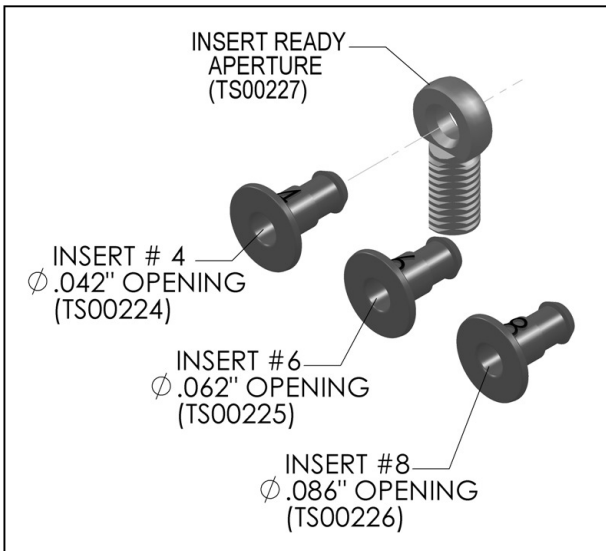

Price

Insert Ready Aperture System

IRAS - **\$15.00 per set**

(Includes 1 steel aperture & 3 inserts)

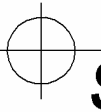
**Tech**  **SIGHTS™**

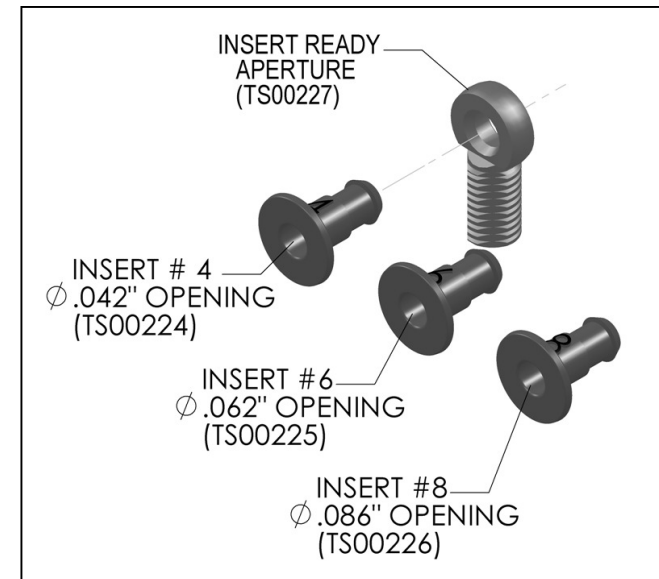

Hartsville, SC 29550

Phone: 843-332-8222  
Email: sales@Tech-SIGHTS.com  
www.Tech-SIGHTS.com

## Assembly Instructions for Insert Ready Aperture System

The Insert Ready Aperture System from Tech-SIGHTS allows the shooter to change the aperture opening size to fit preference and or shooting conditions. The fixed .062 opening aperture is easily replaced with the TS00227 Insert Ready Aperture and accepts three different size urethane inserts. Urethane is a very durable material with incredible memory characteristics that allow it to return to its original shape even after being bumped or pushed out of shape. The combination provides the shooter with an economical quality sight picture for a wide array of shooting conditions.

### INSTALLATION:

***Make sure the firearm is not loaded and is pointed in a safe direction!***

1. Thread the original aperture out of the aperture assembly by rotating the elevation adjustment dial clockwise until the aperture is free of the assembly. (Be careful not to lose the spring wave washer, spring and detent ball).
2. Reassemble the aperture assembly with the Insert Ready Aperture TS00227. Your aperture assembly is now ready to accept the insert of your choosing.
3. Apply a small amount of lubricant to the collar end of the insert as shown in Fig.1. Soap, Motor Oil, Vaseline or similar substances may be used as the urethane inserts are resistant to oil and lubricants. In a pinch, a dab of saliva on the insert and aperture can be used.

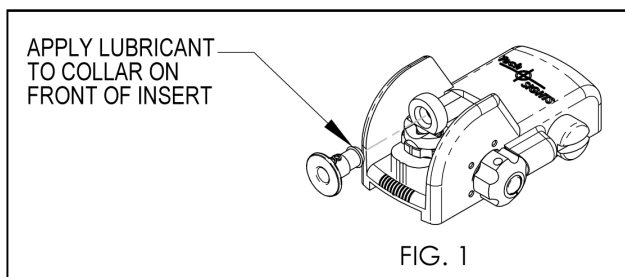

4. Push the collar end of the insert into the opening of the aperture. Push and rotate the aperture to start the insert into the aperture hole as shown in Fig 2. Continue to push and rotate the insert until the insert passes through the aperture so that the collar is showing on the back side of the aperture as shown in Fig 3. A 1/8" diameter rod may be inserted into the end of the insert to aid pushing and rotating if desired - see Fig 4.

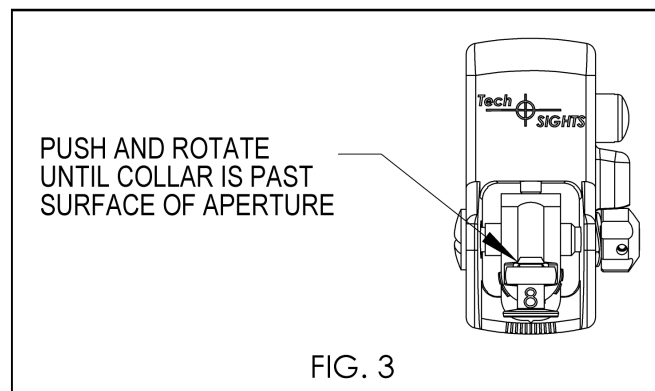
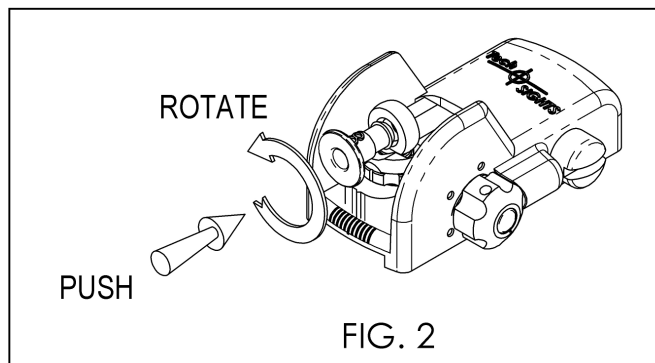

5. Rotate the insert until the number is visible on the top of the insert. This completes the installation of the insert.

### REMOVING THE INSERT

***Make sure the firearm is not loaded and is pointed in a safe direction!***

1. Looking down on the firearm push down slightly on the top of the collar protruding through the aperture as shown in Fig 5.



2. Using the other hand, pull down and back on the flanged end of the insert as shown in Fig. 6. Rotate the insert as you pull it back. This will allow the insert to be removed from the aperture.

